

River's Edge

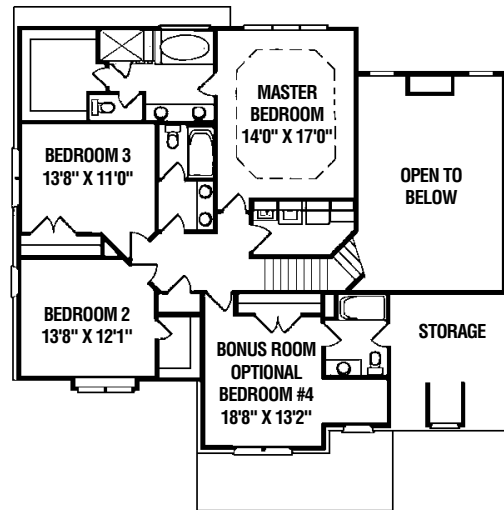

James Towne Homes
Lot # 43 – 103 River Run Road
“The Rivermoor”

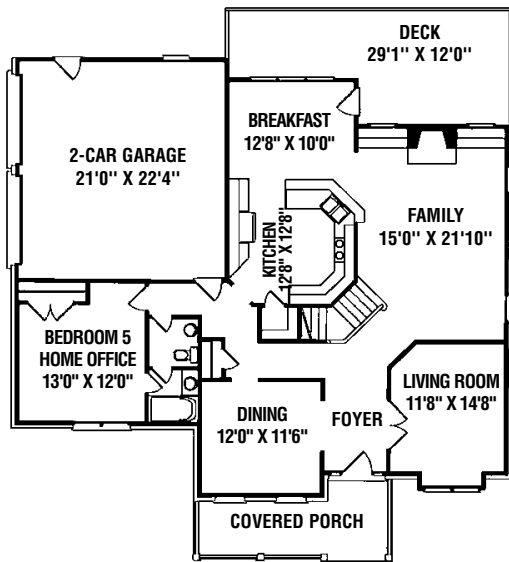

- Brick traditional home with natural cedar shake accents
- Formal living and dining room with coffered ceiling
- Large 2-story family room with fireplace and built-ins
- Gourmet kitchen with pantry and breakfast nook open to over-sized deck
- Downstairs bedroom or home office with full bath
- Spacious upstairs master suite and luxury bath with vaulted ceiling, whirlpool tub, separate shower with seat, double vanities, and large walk-in closet

- Two bedrooms and full bath upstairs
- Bonus room or optional bedroom with full bath
- Walk-in storage room
- Upstairs laundry room with built-in laundry sink and countertop
- Two-car garage
- Approximately 2,908 square feet
- An adaptation of a Frank Betz Associates, Inc. original design



Sales and Marketing by Prudential Carolinas Realty 919-383-4663

Floor plans and renderings are artist's representation and are subject to change without prior notice.

All dimensions are approximate.

All plans are copyrighted, duplication is prohibited.

